

Tillable Soils Map

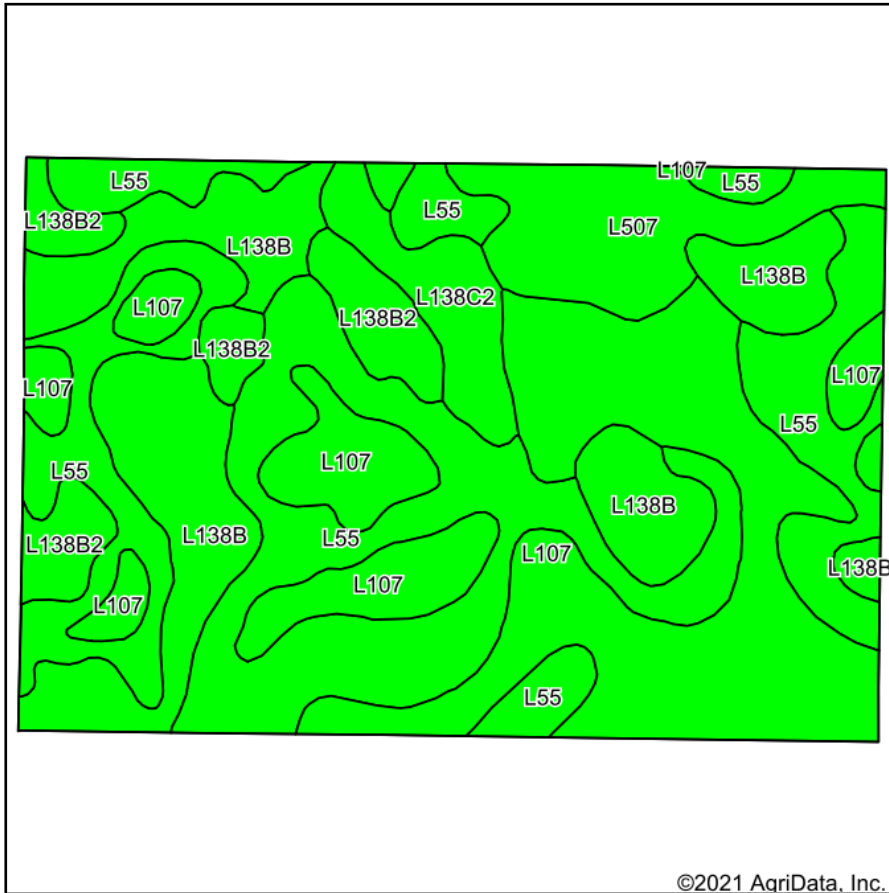

Soils data provided by USDA and NRCS.

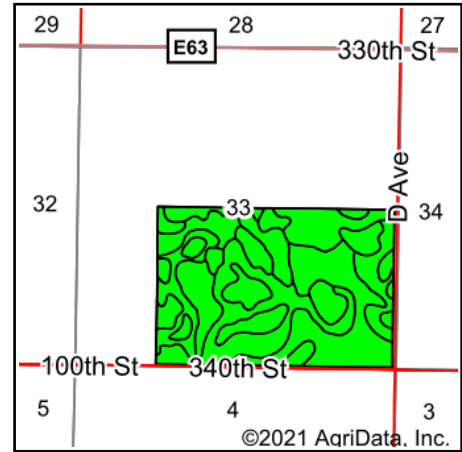

State: **Iowa**
 County: **Greene**
 Location: **33-82N-32W**
 Township: **Willow**
 Acres: **231.73**
 Date: **6/29/2021**



Maps Provided By:



© AgriData, Inc. 2021

www.AgriDataInc.com



Area Symbol: IA073, Soil Area Version: 26

Code	Soil Description	Acres	Percent of field	CSR2 Legend	Non-Irr Class *c	*i Corn	*i Soybeans	CSR2**	*n NCCPI Overall
L55	Nicollet loam, 1 to 3 percent slopes	78.24	33.8%		le	0	0	91	85
L107	Webster clay loam, Bemis moraine, 0 to 2 percent slopes	69.67	30.1%		llw	0	0	88	84
L138B	Clarion loam, Bemis moraine, 2 to 6 percent slopes	43.23	18.7%		lle	220.8	64	88	80
L507	Canisteo clay loam, Bemis moraine, 0 to 2 percent slopes	17.25	7.4%		llw	0	0	87	81
L138B2	Clarion loam, Bemis moraine, 2 to 6 percent slopes, moderately eroded	13.94	6.0%		lle	0	0	85	72
L138C2	Clarion loam, Bemis moraine, 6 to 10 percent slopes, moderately eroded	9.40	4.1%		llle	0	0	83	67
Weighted Average						41.2	11.9	88.6	*n 82

**IA has updated the CSR values for each county to CSR2.

*i Yield data provided by the ISPAID Database version 8.1.1 developed by IA State University.

*n: The aggregation method is "Weighted Average using all components"

*c: Using Capabilities Class Dominant Condition Aggregation Method

Soils data provided by USDA and NRCS.