

Tillable Soils Map

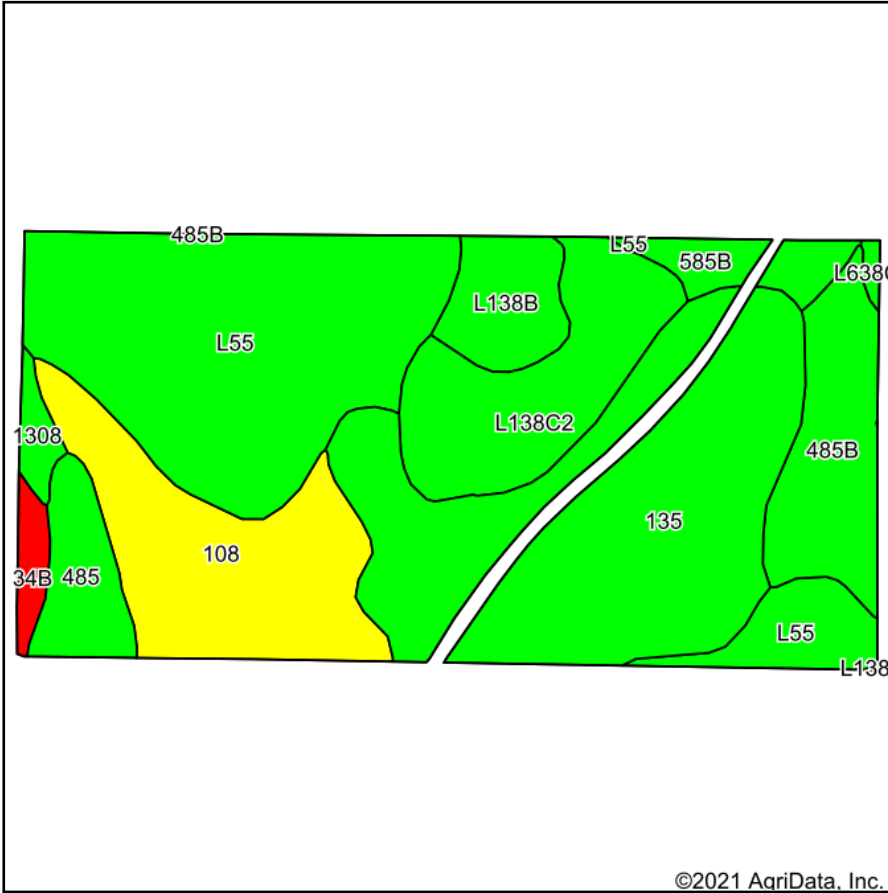

Soils data provided by USDA and NRCS.

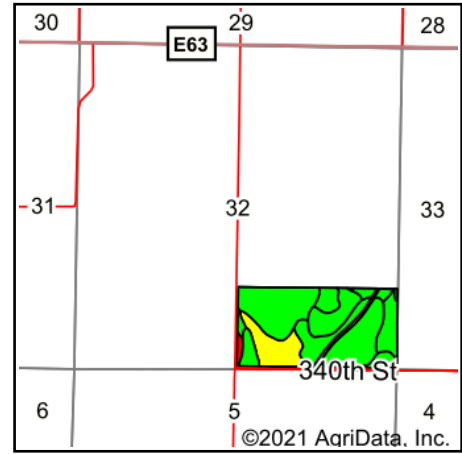

State: **Iowa**
 County: **Greene**
 Location: **32-82N-32W**
 Township: **Willow**
 Acres: **75.41**
 Date: **6/24/2021**



Maps Provided By:



© AgriData, Inc. 2021

www.AgriDataInc.com



Area Symbol: IA073, Soil Area Version: 26

Code	Soil Description	Acres	Percent of field	CSR2 Legend	Non-Irr Class *c	*i Corn	*i Soybeans	CSR2**	CSR	*n NCCPI Overall
135	Coland clay loam, 0 to 2 percent slopes, occasionally flooded	21.24	28.2%		llw	198.4	57.5	76	81	83
L55	Nicollet loam, 1 to 3 percent slopes	20.63	27.4%		le	0	0	91		85
108	Wadena loam, 0 to 2 percent slopes	10.24	13.6%		lls	80	23.2	56		63
L138C2	Clarion loam, Bemis moraine, 6 to 10 percent slopes, moderately eroded	7.77	10.3%		llle	0	0	83		67
485B	Spillville loam, 2 to 5 percent slopes	5.75	7.6%		lle	200	58	88	86	89
L138B	Clarion loam, Bemis moraine, 2 to 6 percent slopes	3.02	4.0%		lle	220.8	64	88		80
485	Spillville loam, 0 to 2 percent slopes, occasionally flooded	2.87	3.8%		llw	208	60.3	88	91	87
585B	Coland-Spillville complex, 1 to 5 percent slopes	1.94	2.6%		llw	195.2	56.6	74	70	92
34B	Estherville sandy loam, 2 to 6 percent slopes	0.91	1.2%		llls	80	23.2	27	20	51
1308	Wadena variant loam, 0 to 2 percent slopes	0.83	1.1%		lls	80	23.2	79	72	89
L638C2	Clarion-Storden complex, Bemis moraine, 6 to 10 percent slopes, moderately eroded	0.21	0.3%		llle	0	0	75		70
Weighted Average						105.6	30.6	79.3	*	*n 79.5

**IA has updated the CSR values for each county to CSR2.

*- CSR weighted average cannot be calculated on the current soils data, use prior data version for csr values.

*i Yield data provided by the ISPAID Database version 8.1.1 developed by IA State University.

*n: The aggregation method is "Weighted Average using all components"

*c: Using Capabilities Class Dominant Condition Aggregation Method

Soils data provided by USDA and NRCS.